

Specification/Data sheet

Stand XS model XS 6 2/3



Article number: 60.31.029

Description

The stand XS ensures safe installation of the iCombi Pro XS, CombiMaster Plus XS 6-2/3 and SelfCookingCenter XS. The cooking system can be fixed on the base frame using a mounting kit.

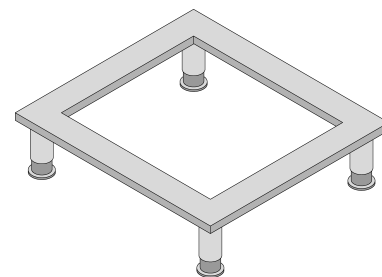

Features

- open on all sides
- Height-adjustable feet (up to 4.5 cm)
- Mounting kit for fixing the cooking system on the base frame
- Levelling by levelling out unevenness or sloping work surface with a max. 2° incline
- Elevation of the unit drain so that it can go over an overflow edge on the working surface of up to 16 cm
- Can be fixed onto the working surface (welded or screwed onto the working surface with threaded bolts)
- The rubber slide protection included prevents the unit from slipping during operation

Technical Specifications

- WxLxH: 629 x 438 x 148 mm (24 3/4 x 17 1/4 x 5 7/8 inch)
- Max. fixed power: 270 kg
- Weight: 4.5 kg

Material

- Rust-free stainless steel (CNS 1.4301)

Specification/Data sheet

Stand XS model XS 6 2/3



Vorderansicht
Front view

Seitenansicht
Side view

Draufsicht
Top view

1:10

mm | inch

**Zeichnungsausdruck unterliegt nicht dem Änderungsdienst!
Printed drawing is not automatically updated! La mise à jour n'est pas assurée sur les plans papier!**

Teilbezeichnung / part name / Désignation Pcs	UG XS	Maßstab Echelle	UG XS	Materialname	
Produkt / project / Projet	W ALL4	Maßstab Echelle	1:5	Materialname	
Erstverwendungs Sous-ensembles	623	Datum Date			
Projekt / project / Projet	W ALL4	Datum Date			
Document number document number	84.00.932	Version Version			
Volume Volum					
Document number document number	60.31.029				
Volume Volum					
Document number document number	629X438X148.2				
Volume Volum					
Document number document number					
Volume Volum					

Technische Änderungen vorbehalten
Technical variation reserved