



DCCOQR

MEAT / DELI / CHEESE / SALAD CASES

Remote Deli Case Combined Serve + Self-Serve

Standard features

- Remote
- Stainless Steel interiors for both serve-over and self service
- Thermostat Electronic Control
- Double Glazed Side Wall Right/Left
- LED Lights
- Wellington ERC2 Electronic Fan Motor
- Aluminum Profile Air Return Grills application
- Stainless Steel Bottom Floor and Fan Cover,
- Electrostatic Powdered Paint For Exterior
- Externally Equalized TXV
- Black or White Painted Outside

Dimensions

Model	DCCOQR-6	DCCOQR-8	DCCOQR-10	DCCOQR-12
Length (inches)	74"	98"	120"	148"
Width (inches)	63"	63"	63"	63"
BTU per foot	780	780	780	780
Power	120V 60HZ	120V 60HZ	120V 60HZ	120V 60HZ
Amperage	2A	2.5A	3A	3.5A
Evaporating Temp	-8C	-8C	-8C	-8C

Above mentioned measurement are from internal part of the equipment. Side panel will be extra

Technical Drawings

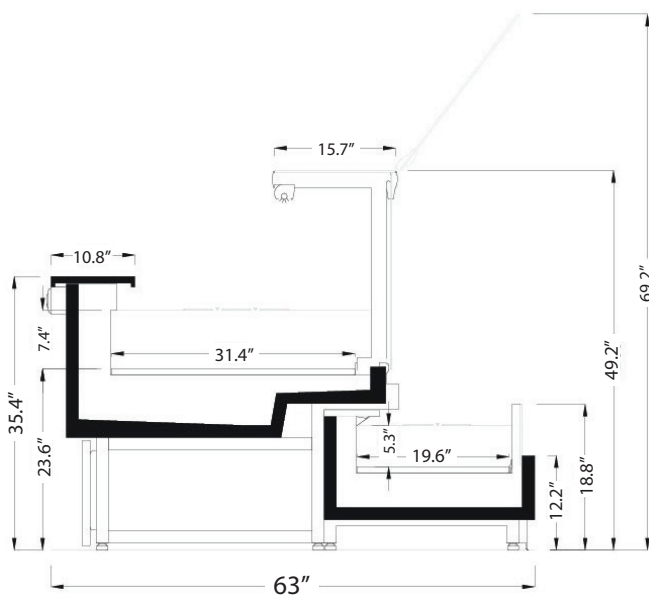

* Customizable options available; * Multiple shelves available; * All measurements are approximates; * Specifications are subject to change without notice; * All equipment are designed to operate in a controlled environment below 75°F (+24°C) temperature and HR 55% relative humidity;