

### CUDHP 3 Shelf

### HIGH PROFILE STRAIGHT GLASS NON-REFRIGERATED PASTRY CASE



CUDHP4

#### Standard Features

- Non-refrigerated pastry case
- Side panels made of black/white coated steel
- Glass shelves with height and angle adjustment
- Bottom shelf made of black/white melamine
- Back sliding doors with combined glass
- Straight front glass
- Each shelf includes LED lighting
- Device leveling legs

#### Options

- Multiple colours available
- Option of multiplexing
- Internal frame available in silver or gold

#### Metal element colours



#### Aluminum profile colours



#### Technical Drawing

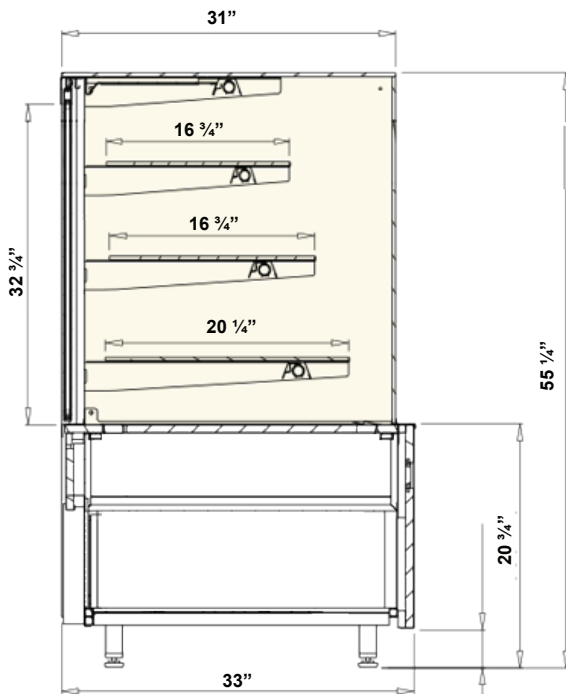

\*\*\*All equipment are designed to operate in a controlled environment below 75°F (+24°C) temperature and HR 55% relative humidity.

#### Dimensions

Model	Dimension W x D x H	Weight (lbs / kg)
CUDHP2	24" x 33" x 54 1/4"	
CUDHP3	36" x 33" x 54 1/4"	
CUDHP4	51 1/2" x 33" x 54 1/4"	
CUDHP6	71 1/2" x 33" x 54 1/4"	

\* **Customizable options available**

\* **Multiple sizes available**

#### Voltage

- CUDHP2 : 115V / 1ph / 60 Hz / 2A, max. fuse: 15A
- CUDHP3,4 : 115V / 1ph / 60 Hz / 3A, max. fuse: 15A
- CUDHP6 : 115V / 1ph / 60 Hz / 6A, max. fuse: 15A

\* Specifications are subject to change without notice.

\*\*All measurements are approximates.