

# 80M

### 3 Shelves, Self Contained

## MULTI-DECK OPEN MERCHANDISERS



80M10

### Standard features

- Internal condenser unit
- Dynamic cooling (Ventilated)
- Display shelves on frame made of powder painted steel
- Ecological polyurethane foam insulation
- Side glass with silk-screen printing
- Upper interior lighting + additional illumination of each shelf - LED Lights
- Automatic condenser vaporization
- Electronic temperature controller with digital display
- Automatic defrost
- Price stripes

### Options

- Other colours available
- Stainless Steel Finish available

#### Plastic price stripe standard colours

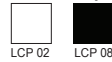

#### Plastic price stripe colours (Under special order)



#### Metal element colours



### Technical Drawings

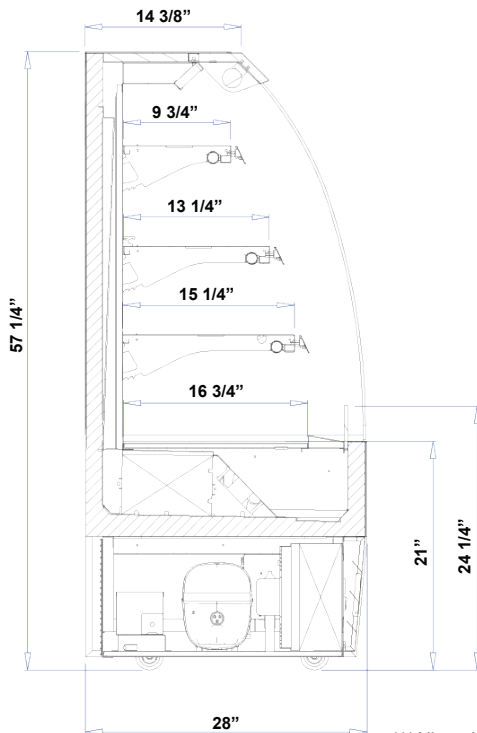

\*\*\*All equipment are designed to operate in a controlled environment below 75°F (+24°C) temperature and HR 55% relative humidity.

### Dimensions

Model	Dimension W x D x H	Weight (lbs / kg)
80M2	25 5/8" x 28" x 57 1/4"	- / -
80M3	36 5/8" x 28" x 57 1/4"	- / -
80M4	49 1/4" x 28" x 57 1/4"	- / -
80M5	65 3/8" x 28" x 57 1/4"	- / -
80M6	78" x 28" x 57 1/4"	- / -
80M8	93 1/2" x 28" x 57 1/4"	- / -
80M10	127 3/16" x 28" x 57 1/4"	- / -

### Voltage

- 80M5: 115V | 1ph | 60 Hz | 15A, max. fuse: 20A
- 80M6,8,10: 2 x 115V | 1ph | 60 Hz | 2 x 15A, max. fuse: 20A

\* Specifications are subject to change without notice.

\*\*All measurements are approximates.