

20M 4 Shelves, Self Contained

33" DEEP HIGH PROFILE MULTI-DECK OPEN MERCHANDISERS



20M6

Standard features

- Self contained
- Dynamic cooling
- Body white finished inside and outside
- ABS sides with glass window
- Price strips - color selection available
- Top internal lighting
- LED lights on all shelves
- Top panel illuminated - Plexiglass color selection available
- Night curtain
- Display shelves (height/angle adjustable)
- Adjustable legs
- Electronic programmable thermostat
- Digital temperature display
- Auto defrost

Options

- Base & front panel color options available
- Stainless steel butcher hangers
- Fruit and vegetable baskets in angled position
- Goods securing fence
- Possibility of multiplexing
- Remote compressor

Plastic sides colors

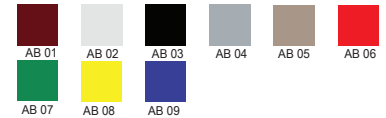

Plastic price stripes colors

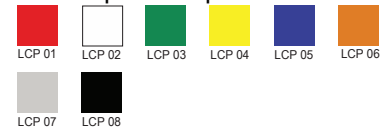

Plastic bumpers colors



Top panels colors



Metal elements colors



Technical Drawings

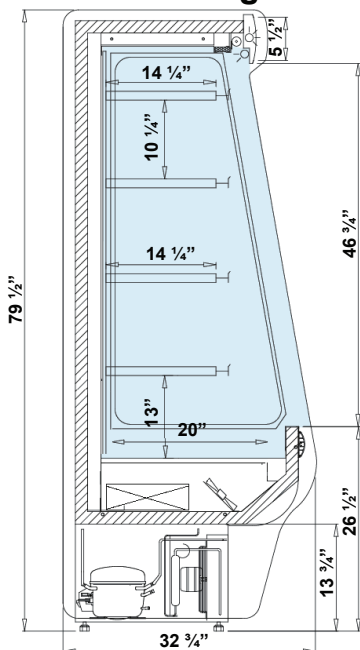

Dimensions

Model	Dimension W x D x H	Weight (lbs / kg)
20M3	39 1/2" x 32 3/4" x 79 1/2"	386 / 175
20M4	51 1/2" x 32 3/4" x 79 1/2"	485 / 220
20M5	63 1/2" x 32 3/4" x 79 1/2"	518 / 235
20M6	75 1/2" x 32 3/4" x 79 1/2"	617 / 280
20M8	100" x 32 3/4" x 79 1/2"	750 / 340

*** Endless lineup, any length available**

Voltage

- 20M3,4 : 115V, 1ph, 60 Hz, 15A, max. fuse: 20A
- 20M5~8 : 115V/ 220V, 1ph, 60 Hz, 11A, max. fuse: 15A

* Specifications are subject to change without notice.

**All measurements are approximates.

***All equipment designed to operate in controlled environment below 75°F (+24°C) temperature and HR 55% relative humidity.

20M 5 Shelves, Remote

33" DEEP HIGH PROFILE MULTI-DECK OPEN MERCHANDISERS



20M6 Remote

Standard features

- Self contained
- Dynamic cooling
- Body white finished inside and outside
- ABS sides with glass window
- Price strips - color selection available
- Top internal lighting
- LED lights on all shelves
- Top panel illuminated - Plexiglass color selection available
- Night curtain
- Display shelves (height/angle adjustable)
- Adjustable legs
- Electronic programmable thermostat
- Digital temperature display
- Auto defrost

Options

- Base & front panel color options available
- Stainless steel butcher hangers
- Fruit and vegetable baskets in angled position
- Goods securing fence
- Possibility of multiplexing
- Remote compressor

Plastic sides colors

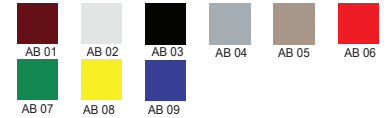

Plastic price stripes colors

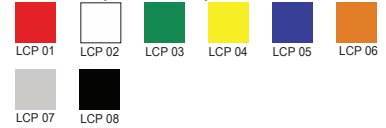

Plastic bumpers colors



Top panels colors



Metal elements colors



Technical Drawings

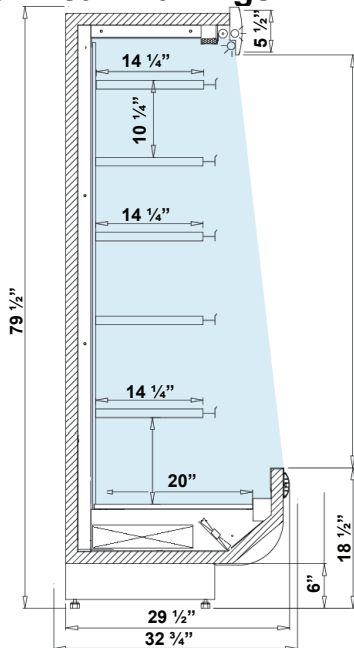

Dimensions

Model	Dimension W x D x H	Weight (lbs / kg)
20M3	39 1/2" x 32 3/4" x 79 1/2"	287 / 130
20M4	51 1/2" x 32 3/4" x 79 1/2"	386 / 175
20M5	63 1/2" x 32 3/4" x 79 1/2"	419 / 190
20M6	75 1/2" x 32 3/4" x 79 1/2"	518 / 235
20M8	100" x 32 3/4" x 79 1/2"	639 / 290

*** Endless lineup, any length available**

Voltage

- 115V, 1ph, 60 Hz, 5A, max. fuse: 15A

* Specifications are subject to change without notice.

**All measurements are approximates.

***All equipment designed to operate in controlled environment below 75°F (+24°C) temperature and HR 55% relative humidity.